

Divisions affected: Cowley.

## **DELEGATED DECISIONS BY CABINET MEMBER FOR TRANSPORT MANAGEMENT**

**21 MARCH 2024**

### **OXFORD: COWLEY CENTRE EAST – PROPOSED AMENDMENTS TO WAITING RESTRICTIONS**

Report by Corporate Director, Environment and Place

#### **RECOMMENDATION**

1. The Cabinet Member for Transport Management is RECOMMENDED to approve the following as advertised:
  - a) On Barns Road introduce new 'No Waiting at Any Time' parking restrictions (double yellow lines),
  - b) on Boswell Road introduce a new two-hour permitted waiting parking bay 'Monday to Saturday 8am-6.30pm with no return within two hours',
  - c) and additional 'No Waiting at Any Time' parking restrictions,
  - d) on Frederick Road introduce new 'No Waiting at Any Time' parking restrictions
  - e) on Bailey Road introduce new 'No Waiting at Any Time' parking restrictions, and
  - f) on St Lukes Road change the existing one-hour parking bays on either side of the carriageway (adjacent to the Telephone Exchange) to become shared-use 'Permit holders' or 'two-hour, no return within two hours' Monday to Saturday 8am-6.30pm, and new sections of 'No Waiting at Any Time' parking restrictions.

#### **Executive summary**

2. Following the implementation of a Controlled Parking Zone in Cowley Centre East in March 2021, as part of the planned monitoring of the operation of the scheme, officers have worked with the local member to consult on localised amendments to address issues raised by local residents and the County Councillor.

3. This report presents responses received to a statutory consultation on the proposals to amend parking & waiting restrictions on Barns Road, Boswell Road, Frederick Road, Bailey Road, and St Lukes Road within the Cowley Central East Controlled Parking Zone (CPZ) in Oxford as shown in **Annexes 1 to 5**.

## **Financial Implications**

4. Funding for consultation on the proposals has been provided from the County Council's Capital Programme and from developer contributions.

## **Equality and Inclusion Implications**

5. No implications in respect of equalities or inclusion have been identified in respect of the proposals.
6. Whilst Officers note that the proposals may have a negative impact on those with mobility issues in terms of parking provision, it is considered that these are mitigated by the fact that in all permit schemes that operate in Oxfordshire, blue badge holders can park with their badge on display in permit bays or areas without time limit or the need to hold a valid permit.
7. Additionally, the County Council will consider any requests for additional dedicated Disabled Persons Parking Places on a case-by-case basis - subject to applicant & site suitability - this is provided free of charge to the applicant, and will provide additional parking capacity for any holder of an authorised, current blue badge.

## **Sustainability Implications**

8. The proposals would help facilitate the safe movement of traffic and alleviate parking stress in the area, and also help facilitate 'active travel' by encouraging the use of alternative sustainable transport modes.

## **Formal Consultation**

9. A formal consultation was carried out between 18 January and 16 February 2024. A notice was published in the Oxford Times newspaper, and an email was sent to statutory consultees & key-stakeholders, including Thames Valley Police, the Fire & Rescue Service, Ambulance service, Bus operators, countywide transport/access & disabled peoples user groups, Oxford City Council, local City Cllr's, and the local County Councillor representing the Cowley division.

10. A letter was also sent directly to 495 properties in the area, and street notices were placed on site in the immediate vicinity adjacent to the proposed changes.
11. 29 responses were received via the online survey during the course of the formal consultation, and these are summarised in the table below:

Proposal	Object	Partially support	Support	No objection	Total
Barns Road	12 (41%)	1 (3%)	15 (52%)	1 (3%)	29
Boswell Road	9 (31%)	3 (10%)	9 (31%)	8 (28%)	29
Frederick Road	9 (31%)	4 (14%)	10 (34%)	6 (21%)	29
Bailey Road	10 (34%)	-	10 (34%)	9 (31%)	29
St Lukes Road	8 (28%)	4 (14%)	9 (31%)	8 (28%)	29

12. Additionally, a further six emails were received from local residents, comprising of three objections & two raising concerns. Thames Valley Police submitted a non-objection.
13. The responses are shown at **Annex 6** and copies of the original responses are available for inspection by County Councillors.

### **Officer response to objections/concerns**

14. Thames Valley Police expressed no objections to the proposals.
15. The County Councillor was approached for his views based on the responses received during the public consultation – Councillor Hicks has responded with the following comments:

*“I am fully supportive of these proposed CPZ changes to help improve the safety of walking and cycling on Barns Road and help to reduce the negative safety impacts of cars parked on street corners. Barns Road is often cited as one of the worst roads to cycle on in all of Oxford. This is socially unjust given that it is a key transport corridor between Blackbird Leys and the rest of the city. These proposals are a step in the right direction to make this route safer and more attractive for active travel to give people healthier and more affordable choices to get around.”*

16. Concerns were raised in respect to the proposed additional double yellow lines restrictions in the controlled zone, and their potential impact on parking availability for residents & their visitors. The proposed addition of double yellow lines continues the theme of the existing restrictions already in the area and



P:\4. Improvement Schemes\Traffic\Traffic and Road Safety\Projects\A - Oxford CPZ 2 Cowley Centre East CPZ\SIGGING & REQUESTS\PROPOSED AMENDMENTS\Cowley East - Amends 22.dwg

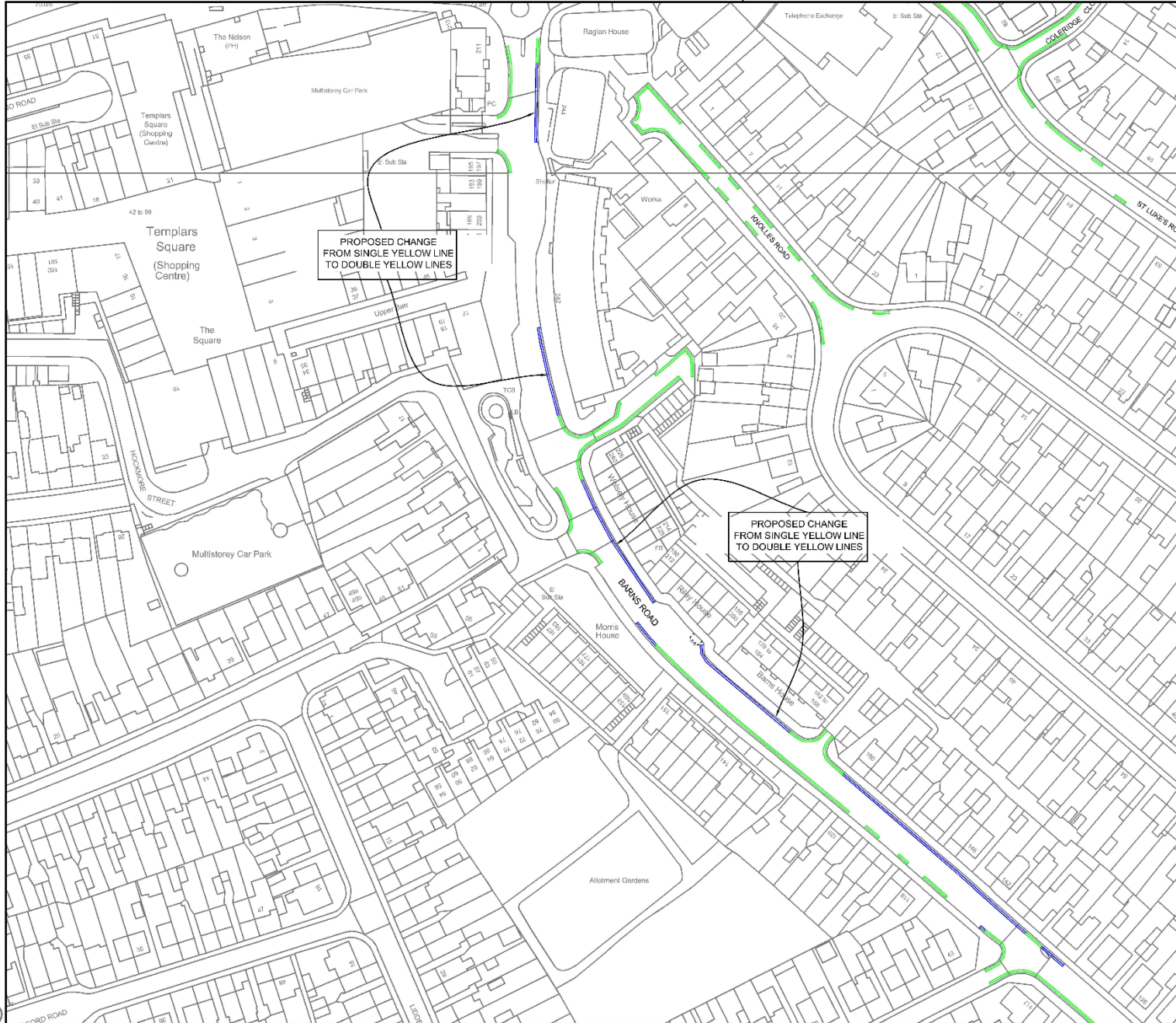

**KEY**

 EXISTING 'NO WAITING AT ANY TIME' (DOUBLE YELLOW LINES) TO REMAIN

 PROPOSED NEW 'NO WAITING AT ANY TIME' (DOUBLE YELLOW LINES)

**SAFETY, HEALTH AND ENVIRONMENTAL INFORMATION**

IN ADDITION TO THE HAZARDS/RISKS NORMALLY ASSOCIATED WITH THE TYPES OF WORK DETAILED ON THIS DRAWING, NOTE THE FOLLOWING SIGNIFICANT RESIDUAL RISKS:

CONSTRUCTION	(ENTER 'NONE' IF APPLICABLE)
MAINTENANCE/CLEANING	(ENTER 'NONE' IF APPLICABLE)
USE	(ENTER 'NONE' IF APPLICABLE)
DECOMMISSIONING/DEMOLITION	(ENTER 'NONE' IF APPLICABLE)

© Crown Copyright and Database rights 10023343 2017

Rev.	Date	Purpose of revision	Drawn	Checked	Approved

 **OXFORDSHIRE COUNTY COUNCIL**

Paul Ferrar  
Director for  
Highways and Operations  
Environment & Place  
Oxfordshire County Council  
County Hall  
New Road  
Oxford  
OX1 1ND  
Tel: 0945 310 1111

Project title  
**COWLEY CENTRE EAST  
'CT'  
PROPOSED RESTRICTION CHANGES**

Drawing title  
**PROPOSED  
NEW DOUBLE YELLOW LINES  
BARN'S ROAD  
OXFORD**

Drawing Status

Scale @ A3	Drawn by	Checked by	Approved by
1:1250	VN	JW	JW
	Date drawn	Date checked	Date approved
	Nov 2023		

Oxfordshire Project No. & File Ref

Drawing No.	PRD/2023/009	Revision	v3
-------------	--------------	----------	----

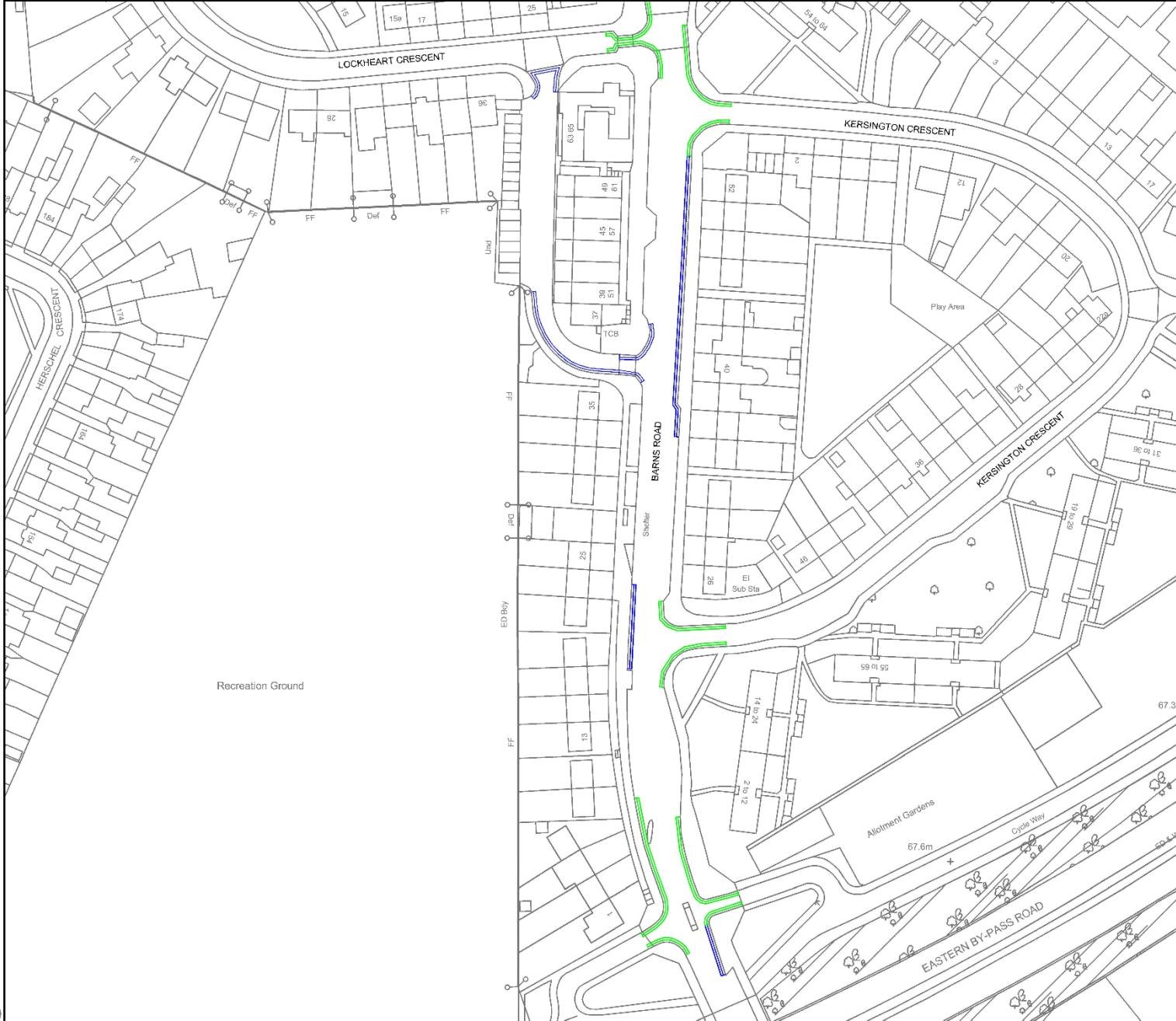

**KEY**

——— EXISTING 'NO WAITING AT ANY TIME (DOUBLE YELLOW LINES)' TO REMAIN

——— PROPOSED NEW 'NO WAITING AT ANY TIME' (DOUBLE YELLOW LINES)

**SAFETY, HEALTH AND ENVIRONMENTAL INFORMATION**

IN ADDITION TO THE HAZARDS/RISKS NORMALLY ASSOCIATED WITH THE TYPES OF WORK DETAILED ON THIS DRAWING, NOTE THE FOLLOWING SIGNIFICANT RESIDUAL RISKS

CONSTRUCTION	(ENTER 'NONE' IF APPLICABLE)
MAINTENANCE/CLEANING	(ENTER 'NONE' IF APPLICABLE)
USE	(ENTER 'NONE' IF APPLICABLE)
DECOMMISSIONING/DEMOLITION	(ENTER 'NONE' IF APPLICABLE)

© Crown Copyright and Database rights 10023343 2017

Rev.	Date	Purpose of revision	Drawn	Checked	Approved



**OXFORDSHIRE COUNTY COUNCIL**

Paul Ferrar  
Director for  
Highways and Operations  
Environment & Place  
Oxfordshire County Council  
County Hall  
New Road  
Oxford  
OX1 1ND  
Tel: 0945 310 1111

Project title

**COWLEY CENTRE EAST  
'CT'  
PROPOSED RESTRICTIONS**

Drawing title

**PROPOSED  
NEW DOUBLE YELLOW LINES  
BARN ROAD  
OXFORD**

Drawing Status

Scale @ A3	Drawn by	Checked by	Approved by
1:1000	VN	JW	JW
	Date drawn	Date checked	Date approved
	Dec 2023		

Oxfordshire Project No. & File Ref

Drawing No.	PRD/2023/008	Revision	v4
-------------	--------------	----------	----



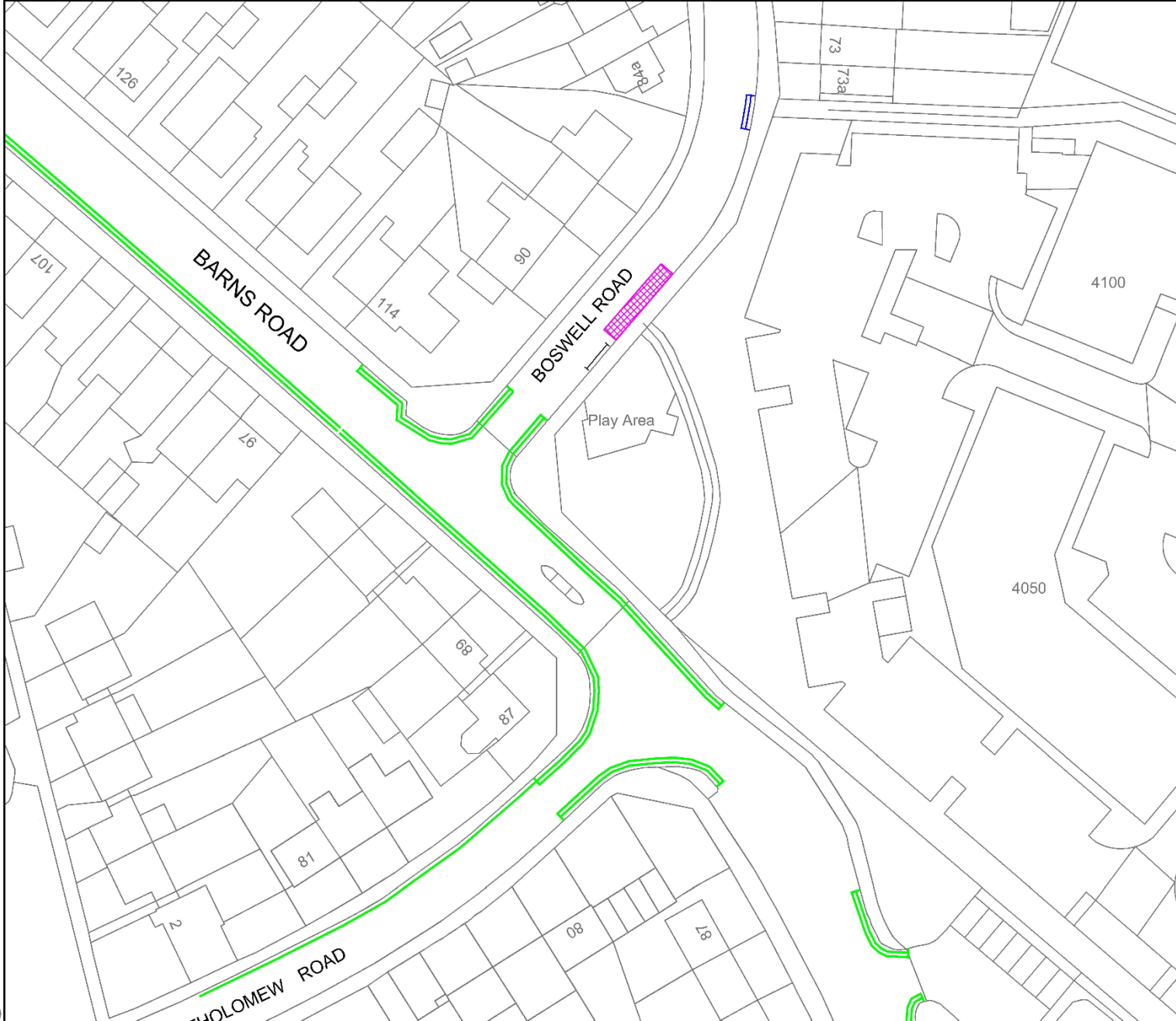

- KEY**
- EXISTING 'NO WAITING AT ANY TIME' (DOUBLE YELLOW LINES) TO REMAIN
  - PROPOSED NEW 2 HOUR LIMITED WAITING PARKING BAY 'MON - SAT 8AM - 6.30PM 2 HOURS NO RETURN WITHIN 2 HOURS'
  - PROPOSED NEW 'NO WAITING AT ANY TIME' (DOUBLE YELLOW LINES)

**SAFETY, HEALTH AND ENVIRONMENTAL INFORMATION**

IN ADDITION TO THE HAZARDS/RISKS NORMALLY ASSOCIATED WITH THE TYPES OF WORK DETAILED ON THIS DRAWING, NOTE THE FOLLOWING SIGNIFICANT RESIDUAL RISKS:

CONSTRUCTION  
(ENTER 'NONE' IF APPLICABLE)

MAINTENANCE/CLEANING  
(ENTER 'NONE' IF APPLICABLE)

USE  
(ENTER 'NONE' IF APPLICABLE)

DECOMMISSIONING/DEMOLITION  
(ENTER 'NONE' IF APPLICABLE)

© Crown Copyright and Database rights 10023343 2017

Rev.	Date	Purpose of revision	Drawn	Checked	Approved

**OXFORDSHIRE COUNTY COUNCIL**

Paul Ferrar  
Director for  
Highways and Operations  
Environment & Place  
Oxfordshire County Council  
County Hall  
New Road  
Oxford  
OX1 1ND  
Tel: 0945 310 1111

Project title  
**COWLEY CENTRE EAST  
'CT'  
PROPOSED PARKING CHANGES**

Drawing title  
**PROPOSED PARKING BAY & YELLOW LINES  
BOSWELL ROAD  
OXFORD**

Drawing Status



Scale @ A3	Drawn by	Checked by	Approved by
1:500	VN	JW	
	Date drawn Nov 2023	Date checked	Date approved

Oxfordshire Project No. & File Ref

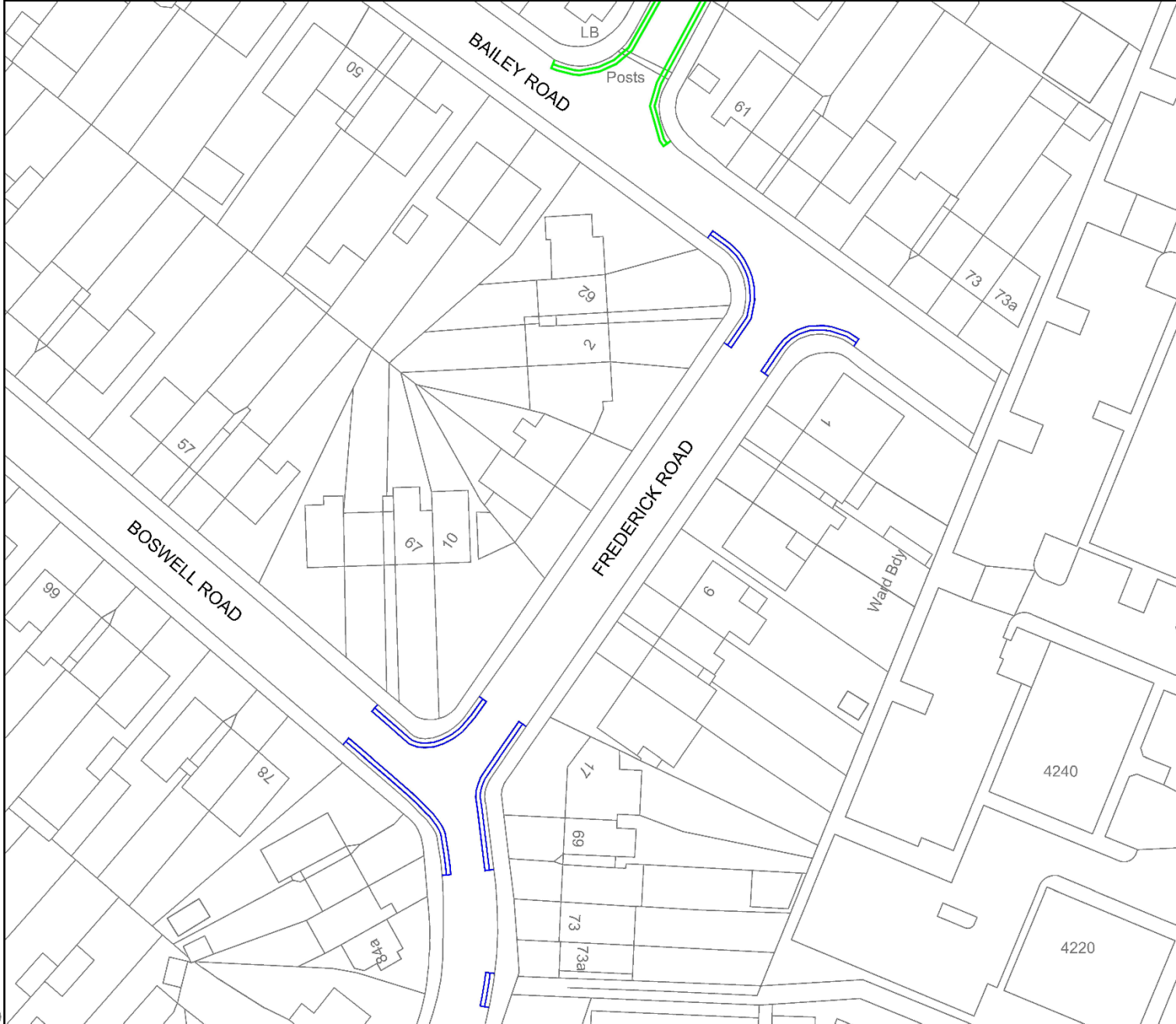
Drawing No.	Revision
PRD/2022/003	v2



**KEY**

	EXISTING NO WAITING AT ANY TIME (DOUBLE YELLOW LINES) TO REMAIN
	PROPOSED NEW NO WAITING AT ANY TIME (DOUBLE YELLOW LINES) RESTRICTIONS

**SAFETY, HEALTH AND ENVIRONMENTAL INFORMATION**

IN ADDITION TO THE HAZARDS/RISKS NORMALLY ASSOCIATED WITH THE TYPES OF WORK DETAILED ON THIS DRAWING, NOTE THE FOLLOWING SIGNIFICANT RESIDUAL RISKS:

CONSTRUCTION	(ENTER 'NONE' IF APPLICABLE)
MAINTENANCE/CLEANING	(ENTER 'NONE' IF APPLICABLE)
USE	(ENTER 'NONE' IF APPLICABLE)
DECOMMISSIONING/DEMOLITION	(ENTER 'NONE' IF APPLICABLE)

© Crown Copyright and Database rights 10023343 2017

Rev.	Date	Purpose of revision	Drawn	Checked	Approved



**OXFORDSHIRE COUNTY COUNCIL**

Paul Ferrar  
Director for  
Highways & Operations  
Environment & Place  
Oxfordshire County Council  
County Hall  
New Road  
Oxford  
OX1 1ND  
Tel: 0945 310 1111

Project title  
**COWLEY CENTRE EAST  
'CT'  
PROPOSED WAITING RESTRICTIONS**

Drawing title  
**PROPOSED WAITING RESTRICTIONS  
FREDRICK RD, BOSWELL RD & BAILEY RD  
OXFORD**

Drawing Status

Scale @ A3	Drawn by	Checked by	Approved by
1:500	VN	JW	
	Date drawn	Date checked	Date approved
	Nov 2023		

Oxfordshire Project No. & File Ref

Drawing No.	Revision
PRD/2022/004	v2



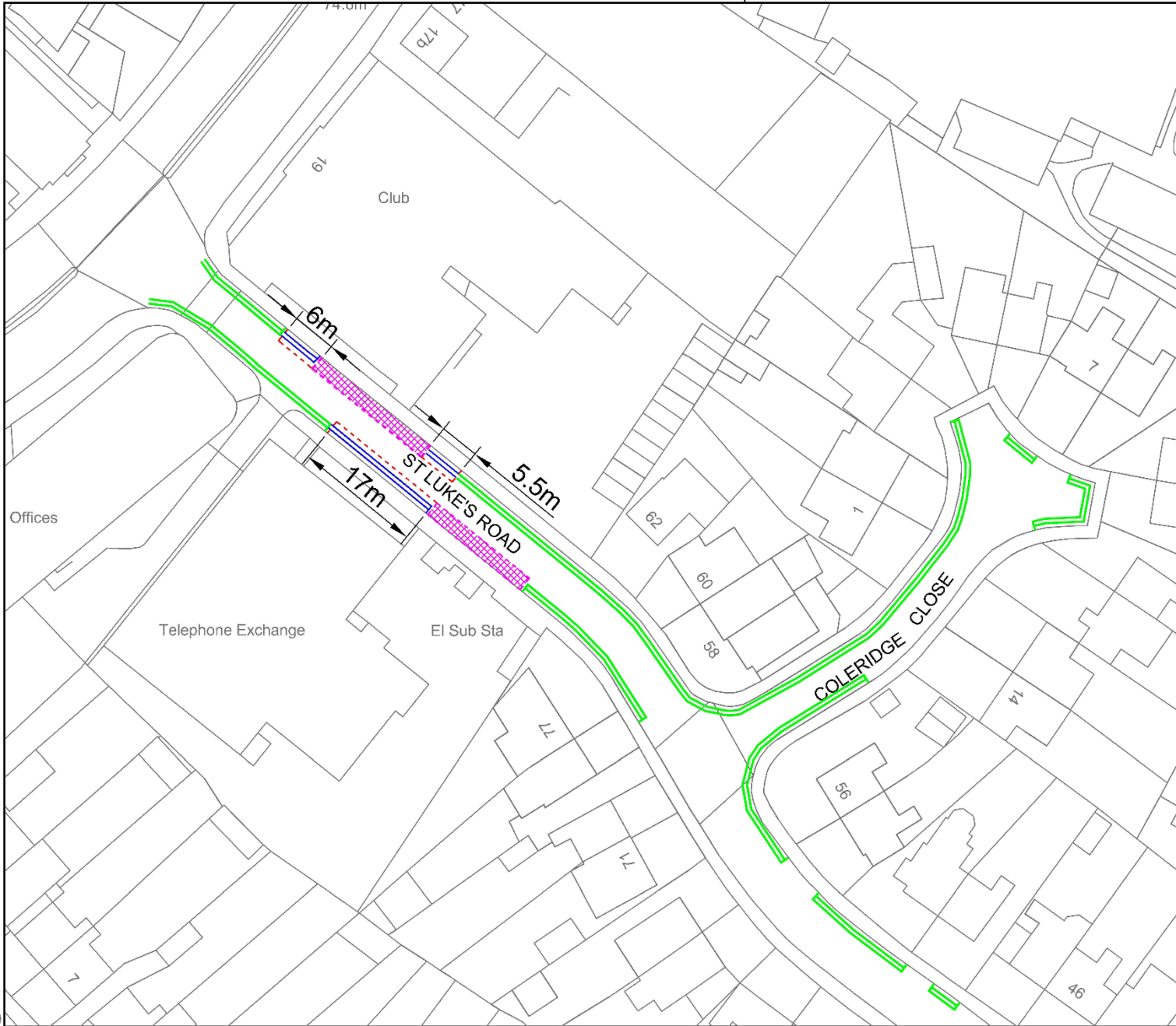

- KEY**
- EXISTING NO WAITING AT ANY TIME (DOUBLE YELLOW LINES) TO REMAIN
  - PROPOSED CHANGE OF EXISTING 1 HOUR PARKING BAY TO DUAL USE 'PERMIT HOLDERS 'CT' OR 2 HOURS NO RETURN WITHIN 2 HOURS MON - SAT 8AM - 6.30PM'
  - - - - - PROPOSED REMOVAL OF EXISTING 1 HOUR PARKING BAY
  - PROPOSED NEW 'NO WAITING AT ANY TIME' (DOUBLE YELLOW LINES)

**SAFETY, HEALTH AND ENVIRONMENTAL INFORMATION**

IN ADDITION TO THE HAZARDS/RISKS NORMALLY ASSOCIATED WITH THE TYPES OF WORK DETAILED ON THIS DRAWING, NOTE THE FOLLOWING SIGNIFICANT RESIDUAL RISKS:

CONSTRUCTION  
(ENTER 'NONE' IF APPLICABLE)

MAINTENANCE/CLEANING  
(ENTER 'NONE' IF APPLICABLE)

USE  
(ENTER 'NONE' IF APPLICABLE)

DECOMMISSIONING/DEMOLITION  
(ENTER 'NONE' IF APPLICABLE)

© Crown Copyright and Database rights 10023343 2017

Rev.	Date	Purpose of revision	Drawn	Checked	Approved

P. J. Ferrar  
 Director for  
 Highways & Operations  
 Environment & Place  
 Oxfordshire County Council  
 County Hall  
 New Road  
 Oxford  
 OX1 1ND  
 Tel: 0945 310 1111

Project title  
**COWLEY CENTRE EAST  
 'CT'  
 PROPOSED PARKING CHANGES**

Drawing title  
**PROPOSED PARKING BAY CHANGES  
 & NEW DOUBLE YELLOW LINES  
 ST LUKES ROAD  
 OXFORD**

Drawing Status

Scale @ A3	Drawn by	Checked by	Approved by
1:500	VN	JW	
	Date drawn Nov 2023	Date checked	Date approved

Oxfordshire Project No. & File Ref

Drawing No.	PRD/2022/002	Revision	v2
-------------	--------------	----------	----

RESPONDENT	COMMENTS
(1) Traffic Management Officer, (Thames Valley Police)	<b>No objection</b>
(2) Local group/organisation, (Cyclox)	<p><b>Barns Road – Support</b>  Barns Road is a key, and at present very poor, cycle route between the largest housing estate in Oxford (and one that is planned to grow in size considerably) and the rest of the city. There are routes that dare you to cycle them, routes that allow you to cycle them and routes that invite you to cycle them. With double parking, parking on pavements and cycle lanes, and busy two-way bus traffic, Barns Road is a serious obstacle to the take-up of active travel and consequently contradicts County transport policy. Reduction and control of parking along Barns Road (so long as it is enforced) will contribute to some extent to improving the situation, and for this reason Cyclox supports the proposals as a small step in the right direction. The only real solution (which is not proposed) would be to remove all vehicle parking from Barns Road and install a protected, segregated, continuous cycle lane. The design standards the County should adhere to are in government directive Local Transport Note 1/20 and all highway proposals should be able to demonstrate how they meet these standards.</p> <p><b>Boswell Road – Support</b>  As above.</p> <p><b>Frederick Road – Support</b>  As above.</p> <p><b>Bailey Road – Support</b>  As above.</p> <p><b>St Lukes Road – Support</b>  As above.</p>

<p>(3) Email response, (unknown)</p>	<p><b>Object</b> – I agree. They should close all the streets and all the people should be on benefits!!!</p> <p>People do not need to work anymore and the businesses should be closed.</p> <p>That is what you are doing!!!</p> <p>Thank you very much for hearing from the people and completely ignoring our rights and killing democracy .</p> <p>The community voted for you to make our lives miserable!!!!</p> <p>I hope you have a good day and that your life is as miserable as you are making ours!!!!</p>
<p>(4) Local resident, (Oxford, Barns Road)</p>	<p><b>Object</b> – Where are residents and their visitors supposed to park?</p> <p>I live opposite one of the proposed areas - namely Barns Road. Barns Road is highly populated with many car owning residents who live in flats as well as houses. Parking is severely restricted at present without the situation being exacerbated even further.</p> <p>As residents we have pay to park in the zone giving the residents in the proposed areas a right to park also.</p> <p>Many permits are issued to the residents, so the money adds up but there isn't adequate parking places for said cars.</p> <p>I understand the need for safe cycling but cyclists contribute nothing towards any of these schemes. You are pitting cyclists against car drivers. This is not conducive for anyone.</p> <p>I see no point in having to renew my permit each year if I will no longer be able to park in the road I reside in.</p> <p>This is not a well thought out proposal put forward by Cowley's county counsellor, yet again!!!</p>
<p>(5) Local resident, (Oxford, Barns Road)</p>	<p><b>Object</b> – I am writing to object to the County Council's proposal to install double yellow lines along the section of the Highway of Barns Road which fronts our property, number 144. At the moment we are paying the council a CPZ charge in order to be able to park our vehicles along Barns Road.</p>

	<p>This new parking restriction will remove this ability and we need the vehicle for out of town work purposes. The new restriction means that we cannot park suitably on Barns Road. Having a vehicle for us is not a luxury, it is needed to commute to work outside of Oxford, and, public transport or cycling is not an option. I remind you we need to work in order to pay our Council Tax which goes to fund the Council, plus we are paying an annual fee for the privilege of parking within a Residents Parking Zone.</p> <p>You say removing parked cars reduces obstruction to traffic. All this does is increase traffic speed, when people see a clear road they automatically increase their speed. If you lived on Barns Road you would know this as this is our lived experience. The biggest culprits of this are the numerous buses we have travelling along Barns Road. We therefore object to the proposed amendments.</p>
(6) Local resident, (Oxford, Frederick Road)	<p><b>Concerns</b> – I live in Frederick road and I am surprised by the proposal to increase the parking restrictions in my road because it is a short wide road with very little through traffic - mostly this is delivery vans and motorbikes.</p> <p>Whilst there are benefits to minimising the number of people parking for prolonged periods of time in residential areas it is my observation that very few cars use Frederick Road for non-visitors to residents and our current restrictions are more restrictive than roads nearer to town such as crescent road . Our restrictions include Saturdays and are longer 8am - 6.30. This means that residents in our road have to use permits almost all social hours except Sundays. Please could you send officers to look at the minimal roadside parking in Frederick Road before you take a decision to increase restrictions.</p> <p>Recently all day/night parking on the lefthand side of the bend where Boswell Road joins Bailey Road has created a high risk of accidents because traffic coming round that bend from Boswell road has no view of oncoming traffic from Bailey Road. There is a property for sale on that corner and hence if that is multioccupancy the problem will increase. Prohibiting parking at all times, and then enforcing the new restrictions would be very reassuring.</p> <p>While you are considering parking in this area may I ask whether you are aware that exiting Boswell road onto Barns Road is dangerous because the parked cars (in the disabled space) obstruct the view of oncoming cycles , scooters and cars. As Barns Road on a slight downhill incline, car drivers sitting in their car at the junction cannot see traffic approaching down Barns Road from Templar Square, except for high sided vehicles such as buses . The oncoming cars will be able to see the bonnet of my car as I inch out of Boswell Road but I am forced to pull out without knowing whether or not the way is clear . I am conscious that in the event of an accident I would be held responsible.</p>

	<p>By sharing this concern with you here I am also sharing responsibility for my safety on the road and would make any insurance company aware that an accident might have been unavoidable.</p> <p>I have submitted this concern to the highways dept online but simply advised to repeat the process to another online system with photos etc and I simply dont have time - I believe it is the Highways dept responsibility to forward enquiries to the appropriate dept . And, I cant take photos to demonstrate because it would be illegal , dangerous and obstructive to sit in my car at the junction and take photos to illustrate the restricted view from the car drivers perspective.</p> <p>I hope you will be willing to take my safety concern seriously by prohibiting parking on Barns Road so close to Boswell Road and moving the disabled bay further up the road towards Templar Square.</p>
<p>(35) Local resident, (Oxford, Barns Road)</p>	<p><b>Concerns</b> – My concerns regarding double yellow lines outside my house is the lack of residential parking in this area and the recent building of multiple flats with no allocated parking, that is why so many cars are parked on pavements.</p> <p>This affects me and other close residents as in the turning to the lane behind my house there are double yellow lines which are ignored every day and also next to the garages between Barns Road and Bailey Road to the rear of us, again ignored all the time.</p> <p>I require access to my parking spot at the rear of my house as do other neighbours so can you please ensure that you protect our access by repainting and enforcing the existing yellow lines. Once the new parking restrictions come into force I know that our current problem with illegal parking and access will get worse and who will solve this problem on our behalf?</p>
<p>(7) Local resident, (Oxford, Barns Road)</p>	<p>Barns Road – <b>Object</b> It's hard enough to park as it is without taking yet more spaces away from residents. Unless there is going to be alternative parking spaces put in then no</p> <p>Boswell Road – <b>Object</b></p> <p>Frederick Road – <b>Object</b></p> <p>Bailey Road – <b>Object</b></p>



	<p>St Lukes Road – <b>Object</b></p>
<p>(8) Local resident, (Oxford, Barns Road)</p>	<p><b>Barns Road – Object</b> Where are all the residents cars supposed to go? I live opposite the proposed new double yellow lines and it is already difficult to park here without pushing all the cars to one side of the road? Surely you know how many permits you have issued to residents on Barns Road, it feels like you want to take the permit money without providing adequate parking for the permit holders! I understand the need for safe cycling but again you're pitting cyclists and car drivers against each other! Where was the feedback obtained from as yet again no one speaks to the residents of Barns Road!</p> <p><b>Boswell Road – No objection</b></p> <p><b>Frederick Road – Object</b> The same reasons as for Barns Road.</p> <p><b>Bailey Road – Object</b> Same reasons as Barns Road.</p> <p><b>St Lukes Road – Object</b> The same reasons as Barns Road.</p>
<p>(9) Local resident, (Oxford, Barns Road)</p>	<p><b>Barns Road – Object</b> I am objecting because we need our car to work and care for elderly family members and you are destroying our lives we this dictatorship is against our democratic right to work and be able to enjoy our leisure time. What you want you do even if we vote against although we voted for you for over 30 years we don't count!!!</p> <p><b>Boswell Road – Object</b> People need their cars to work and you are destroying this country with these proposals as if we can't have cars we will be applying for state benefits as the jobs are not all on bus routes like yours!!!</p> <p><b>Frederick Road – Object</b></p>

	<p>Most people need their cars because it is their livelihood and you are encouraging people to give up work and apply for benefits. Please wake up!!!</p> <p>Bailey Road – <b>Object</b> Again people need their cars to work just stop with the ignorant ideas and do what we voted you for.</p> <p>St Lukes Road – <b>Object</b> Listen to your community for once and support those who pay taxes and need their cars to make a living. You are destroying this community!!!</p>
<p>(10) Local resident, (Oxford, Barns Road)</p>	<p>Barns Road – <b>Object</b> By implementing these proposed NEW 'NO WAITING AT ANY TIME' (DOUBLE YELLOW LINES) you will stop a significant amount of local residents from being able to go work as cycling and bus routes are not possible for a lot of working class people like myself as I am a trades person who works in many different location and require a vehicle to transport myself to different location both in oxford and outside of oxford. if this proposal goes through and I am unable to go to work due to not being able to park my vehicle I will simply go on benefits as I have no other option. I fully believe that the opinion of myself and others who object will not be heard as the majority of local residents objected to the LTNS currently in place and yet it still got approved. I sincerely hope someone in the county council sees sense and makes the right decision and chooses not to destroy countless working family homes.</p> <p>Boswell Road – <b>Object</b> As above.</p> <p>Frederick Road – <b>Object</b> As above.</p> <p>Bailey Road – <b>Object</b> As above.</p> <p>St Lukes Road – <b>Object</b> As above.</p>

<p>(11) Local resident, (Oxford, Barns Road)</p>	<p>Barns Road – <b>Object</b> Forcing the residents to cycle when they work miles away</p> <p>Boswell Road – <b>Object</b> Making people take public transport and sell their cars</p> <p>Frederick Road – <b>Object</b> Making people walk</p> <p>Bailey Road – <b>Object</b> Making people walk</p> <p>St Lukes Road – <b>Object</b> Making people work</p>
<p>(12) Local resident, (Oxford, Barns Road)</p>	<p>Barns Road – <b>Object</b> I live on Barns Road and the previous parking zone put a double yellow line directly outside my house and a single yellow on the opposite side. This very challenging for having visitors (we have a baby and friends with similar aged children can't commute easily without a car) but at least on Sundays and evenings we were able to have visitors and they could park opposite. Now with the new plans we would have no available parking even with permits anywhere near our house which is even more challenging when our parking permit only allows for parking in some of the side streets as there are different parking zones for the various close side streets and therefore there is no longer an expectation of being able to find parking in evenings and Sundays within a walking distance of our house (with very young children). It's even more challenging when the LTN blocks access to some areas for potential parking and is what has made Barns Road such a busy road that during busy periods I struggle to cross the road using the island near our house (ie without traffic lights). Further if you are worried about cyclists etc why don't you make Barns Road a 20mph zone as for every single road in the area rather than having traffic trying to race along here at more than 30mph</p> <p>Boswell Road – <b>Partially support</b> Not ever seen here as a parking issue , not sure I've understood the reason for this change properly</p> <p>Frederick Road – <b>Partially support</b></p>

	<p>Not sure I've personally seen a problem and understand how this will actually be beneficial</p> <p>Bailey Road – <b>Object</b> Not sure I've seen an issue and how this is actually going to be a benefit for the residents</p> <p>St Lukes Road – <b>Partially support</b> Not sure I've personally seen the problem and therefore not convinced this will be an actual benefit to the residents</p>
<p>(13) Local resident, (Oxford, Barns Road)</p>	<p>Barns Road – <b>Object</b> You installing double yellows along Barns Road is going to cause even more problems than what we have now. There is not enough parking on Barns Road as it is and most of the houses do not have the facilities to create a driveway so have to park on the road with a permit. If you are going to install double yellows then you need to let Barns Road's residents park in the side roads i.e. expand the CT zone</p> <p>Boswell Road – <b>Object</b> There is not enough parking for the residents as it is</p> <p>Frederick Road – <b>Object</b></p> <p>Bailey Road – <b>Object</b></p> <p>St Lukes Road – <b>Object</b></p>
<p>(14) Local resident, (Oxford, Barns Road)</p>	<p>Barns Road – <b>Object</b> I have one car and I have a CT parking permit. I need my car for part of the work that I do. It is already difficult to find an available parking permit space on Barns Road and I know it will make it much more difficult to find a space if the area between 160 and 140 is removed as available resident parking, i.e. if it is changed to double yellow banding. I support double yellow banding of the other areas as a proposal but people currently utilise those areas extensively - again I believe there would be an impact on residents with cars and make it much more difficult to park in the legitimate residents' parking areas, especially on Sundays when there is currently no restriction.</p> <p>Boswell Road – <b>Support</b></p>

	<p>I don't think this will have much impact</p> <p><b>Frederick Road – Support</b> I support this but again removal of legitimate out of hours parking will have an impact on residents' parking in CT zone.</p> <p><b>Bailey Road – No objection</b> I don't think this will have much impact although I can't see a map relating specifically to this road.</p> <p><b>St Lukes Road – Partially support</b> Again, removing available CT residents parking will have a knock-on effect and make life harder for currently residents without their own parking area.</p>
<p>(15) Local resident, (Oxford, Barns Road)</p>	<p><b>Barns Road – Object</b> you are taking away parking for residents who have paid for resident parking you will be isolating the people who live along barns road and the disadvantages of limited access for careers and visitors to the elderly and the disable and ill i think you forget that people do live along this road</p> <p><b>Boswell Road – Object</b> waste of time this is not through road</p> <p><b>Frederick Road – Object</b> cannot see the point no through road no heavy traffic</p> <p><b>Bailey Road – Object</b> the road is blocked off so cannot see the need</p> <p><b>St Lukes Road – Partially support</b> is this to help out the new student housing or local residents ?</p>
<p>(16) Local resident, (Oxford, Barns Road)</p>	<p><b>Barns Road – Object</b> I am a resident in barns road maisonettes ,The reason why I am objecting to this is because this would make it impossible to park my car , it is already very difficult to park already , I feel that this new proposal will just push cars</p>



	<p>further up the road to where there is already limited spaces , I have applied for garages only to be told there are none , when it is clear some have not been touched for months and some years , I have been a resident for more than 20 years and this is going to make things very hard indeed, I have mentioned to council to make the unused communal garden in to spaces for residents to have one space per flat only to be told this wouldn't work and would be too expensive ,I am at a loss of words as to what we will do as me and my husband both need our vehicles to travel to work in kidlington. I hope we can come to some sort of plan that helps out local residents and not vehicles that park here all day ignoring the permits needed</p> <p>Boswell Road – <b>No objection</b></p> <p>Frederick Road – <b>No objection</b></p> <p>Bailey Road – <b>No objection</b></p> <p>St Lukes Road – <b>No objection</b></p>
<p>(17) Local resident, (Oxford, Barns Road)</p>	<p><b>Barns Road – Object</b></p> <p>Living in a ground floor maisonette with no off road parking due to having a communal garden on the barns road we cannot park any of our vehicles off road. Oxford city council do not have any garages for rent in our area. Due to having 4 children living at my address and being self employed I currently need 2 vehicles. One of these vehicles is to transport myself and children around and the 2nd vehicle is my work van which doesn't have the capacity seating to safely carry my children. I have a parking permit for the area CT for my passenger vehicle but Oxfordshire county council will not issue me with a 2nd permit for my 2nd vehicle because I currently registered one for my passenger vehicle. When approaching Oxfordshire county council with regards to this they suggested to changed my passenger vehicle into my eldest daughters name and they could issue her with a permit. As I stated to Oxfordshire county council that how does this work with my insurance due to me not being the registered owner of the vehicle so then Oxfordshire county council then suggested to put the insurance in her name with me as named driver, I then suggested that a 17 year old provisional licence holder trying to insure a audi s4 3.0litre supercharged would be an issue. Oxfordshire country council said that the only way to get around it was to give me visitors permits, the permits they issued me only last a month and I cannot reapply for any permits for 6 months. I am already at a lost cause because being self employed and finishing work at 3pm most days I'm already having to go and visit family until the 6.30pm parking comes into force. By making this a no waiting at anytime area would be a total mess and will force all residents that live in the maisonettes at barns road to park there vehicles further down the road which is already full with people parking there vehicles. I have also approached Oxford city council about converting our communal garden</p>

	<p>that's facing barns road into off street parking for the resident's of the barns road maisonettes (whosley house and Riley house) and there answer was they don't have the funds. I hope you can see my point of view on this situation as it will cause total mayhem for residents that live in the area of CT barns road.</p> <p>Boswell Road – <b>Object</b> As above.</p> <p>Frederick Road – <b>Object</b> As above.</p> <p>Bailey Road – <b>Object</b> As above.</p> <p>St Lukes Road – <b>Object</b> As above.</p>
(18) Local resident, (Oxford, High Street)	<p>Barns Road – <b>Object</b> Traffic in Oxford is terrible and you will make it worse.</p> <p>Boswell Road – <b>Object</b> As above.</p> <p>Frederick Road – <b>Object</b> As above.</p> <p>Bailey Road – <b>Object</b> As above.</p> <p>St Lukes Road – <b>Object</b> As above.</p>
(19) Local resident, (Oxford, Bailey Road)	<p>Barns Road – <b>Partially support</b></p>

	<p>My main issue with Barns road is turning right out of Boswell road onto Barns road it is impossible to see traffic coming because of parked cars. I would like to see the plan for double yellow lines extended to that area whereas on the plans the changes do not reach that far down Barns Road.</p> <p><b>Boswell Road – Support</b> I think this is wise as people park all over the exit of Boswell road making it dangerous to turn in and out.</p> <p><b>Frederick Road – Support</b> This is sensible because people park all over these corners which is dangerous as a cyclist and a driver.</p> <p><b>Bailey Road – Support</b> This is helpful because people park on corners dangerously.</p> <p><b>St Lukes Road – Support</b> This seems helpful.</p>
(20) Member of public, (Oxford, Augustine Way)	<p><b>Barns Road – Support</b> Barns Road is busy and parked cars introduce conflict.</p> <p><b>Boswell Road – No objection</b></p> <p><b>Frederick Road – No objection</b></p> <p><b>Bailey Road – No objection</b></p> <p><b>St Lukes Road – No objection</b></p>
(21) Local resident, (Oxford, Bailey Road)	<p><b>Barns Road – Support</b> Hopefully this will stop people parking and blocking cyclists.</p> <p><b>Boswell Road – No objection</b></p>

	<p>Frederick Road – <b>Support</b> Cars parking on the junctions cause obstructions when turning.</p> <p>Bailey Road – <b>Support</b> Cars parking on the junction cause obstructions</p> <p>St Lukes Road – <b>No objection</b></p>
(22) Local resident, (Oxford, Barns Road)	<p>Barns Road – <b>Support</b> free flow of buses and cyclists</p> <p>Boswell Road – <b>Partially support</b> affecting residents</p> <p>Frederick Road – <b>Partially support</b> affecting residents</p> <p>Bailey Road – <b>Support</b> good</p> <p>St Lukes Road – <b>Partially support</b> it will increase illegal parking on st. Lukes road and Coleridge close. Please make an YELLOW JUNCTION BOX or KEEP CLEAR box on Between Towns Road with St. Lukes Road</p>
(23) Local resident, (Oxford, Barns Road)	<p>Barns Road – <b>Support</b> Fully endorse this proposal. I believe it will significantly enhance road safety for vehicles, bicycles, and pedestrians alike. Additionally, it effectively expands accessibility to visitor parking within the vicinity, promoting convenience for all. The proposal is balanced, addressing needs of various stakeholders. I would like to advocate for the consideration of implementing a 20mph speed limit around the Barns Road / Between Towns Road area to mitigate noise and minimize the impact of building vibrations on local residential properties, particularly from heavy vehicles navigating damaged road surfaces. I appreciate the opportunity to provide input on this matter.</p>

	<p><b>Boswell Road – Support</b> Fully endorse this proposal. I believe it will significantly enhance road safety for vehicles, bicycles, and pedestrians alike. Additionally, it effectively expands accessibility to visitor parking within the vicinity, promoting convenience for all. The proposal is balanced, addressing needs of various stakeholders.</p> <p><b>Frederick Road – No objection</b> I have no concerns.</p> <p><b>Bailey Road – No objection</b> I have no concerns.</p> <p><b>St Lukes Road – No objection</b> I have no concerns.</p>
<p>(24) Local resident, (Oxford, Beresford Place)</p>	<p><b>Barns Road – Support</b> This is a major improvement on one of the worst cycle routes/roads in all of Oxford (Barns Road) and also improves safety around various other junctions which is in line with visionzero. Bringing more coherence in parking arrangements is also a helpful step.</p> <p><b>Boswell Road – Support</b> Makes sense to have the road clear at the footpath entrance and have a small sensible short-term parking arrangement</p> <p><b>Frederick Road – Support</b> Major improvements in visibility at junctions is key for children and vulnerable road users particularly and should be standard.</p> <p><b>Bailey Road – Support</b> As before.</p> <p><b>St Lukes Road – Support</b> Bringing coherence is helpful, as well as better visibility at junctions.</p>



<p>(25) Local resident, (Oxford, Between Towns Road)</p>	<p><b>Barns Road – Support</b> Because my sister lives there and everytime i visiet her im getting ticket fine and she never find a place to park she havent driveway or garage she have to park far way after long shift working for nhs .</p> <p><b>Boswell Road – Partially support</b> No objection</p> <p><b>Frederick Road – Partially support</b> Wrong</p> <p><b>Bailey Road – No objection</b></p> <p><b>St Lukes Road – Support</b> Wrong</p>
<p>(26) Member of public, (Oxford, Boundary Brook Road)</p>	<p><b>Barns Road – Support</b> The whole of Oxford should be covered by CPZs. Free parking should not exist in Oxford. We need to do everything possible to discourage the use of cars in our city due to their numerous detrimental impacts on people the environment.</p> <p><b>Boswell Road – Support</b> As above.</p> <p><b>Frederick Road – Support</b> As above.</p> <p><b>Bailey Road – Support</b> As above.</p> <p><b>St Lukes Road – Support</b></p>

	As above.
(27) Local resident, (Oxford, Crescent Road)	<p><b>Barns Road – Support</b> As a cyclist, I find Barns Road dangerous for bikes. The current parking controls are not enforced so cars park wherever they like including on the segregated cycling lanes which are not enforceable it seems making visibility and space for cycles restricted. Barns Road is one of the few routes in and out of Blackbird Leys given the road is super narrow in places parking should be moved onto adjacent roads to optimise visibility and space for pedestrians and cyclists as this road is only going to get busier with the new Blackbird Leys District Centre and Knights Road developments making this artery more important for busses, bikes, and pedestrians in places the pavement is not wide enough.</p> <p><b>Boswell Road – No objection</b> Given Boswell Road is close to Barns Road I think the focus needs to be on Barns Road first as there will be cars that are displaced from Barns Road.</p> <p><b>Frederick Road – Support</b> This road is a through route for bikes and pedestrians coming from Phipps Road, visibility and access would be reduced if a lot of extra cars from Temple Cowley shops parked there looking forward.</p> <p><b>Bailey Road – Support</b> I'm supporting to reduce traffic in Oxford and encourage people to use alternative modes of transport.</p> <p><b>St Lukes Road – Support</b> I'm supporting to reduce traffic in Oxford and encourage people to use alternative modes of transport.</p>
(28) Local resident, (Oxford, Rymers Lane)	<p><b>Barns Road – Support</b> I cycle along this road frequently and the restrictions will improve cycling safety.</p> <p><b>Boswell Road – Support</b> This is part of my bicycle commute to the science park - the changes will improve safety for pedestrians and cyclists</p>

	<p>Frederick Road – <b>Support</b> Needless to say, no one should park on these junctions, this is a no brainer</p> <p>Bailey Road – <b>Support</b> No one should park at the junction</p> <p>St Lukes Road – <b>Support</b></p>
(29) Member of public, (Oxford, Southfield Park)	<p>Barns Road – <b>Support</b> Barns Road is dangerous for cycling. Removing parked cars will provide space and improve visibility.</p> <p>Boswell Road – <b>No objection</b></p> <p>Frederick Road – <b>No objection</b></p> <p>Bailey Road – <b>No objection</b></p> <p>St Lukes Road – <b>No objection</b></p>
(30) Member of public, (Oxford, Southfield Road)	<p>Barns Road – <b>Support</b> Current road layout has horrible bike path close to parking cars. Most houses in that area have private parking space anyways so the current parking space is not necessary to this degree</p> <p>Boswell Road – <b>Support</b> This road is a good shortcut for cyclist/pedestrian coming from temple cowley shopping area/barns road to the business park (via Knolle Rd). It would be good to make the small entrance in Knolle Rd better accessible for cyclists from the road, e.g. by optimizing the lowering of the sidewalk</p> <p>Frederick Road – <b>No objection</b></p> <p>Bailey Road – <b>No objection</b></p> <p>St Lukes Road – <b>No objection</b></p>

(31) Local resident, (Oxford, Southfield Road)	<p>Barns Road – <b>Support</b> Cycling safety improvements</p> <p>Boswell Road – <b>Support</b> Cycling safety improvements</p> <p>Frederick Road – <b>Support</b> Cycling safety improvements</p> <p>Bailey Road – <b>Support</b> Cycling safety improvements</p> <p>St Lukes Road – <b>Support</b> Cycling safety improvements</p>
(32) Member of public, (Oxford, Stratfield)	<p>Barns Road – <b>Support</b> These are essential for safe cycling and unimpeded movement of buses and emergency vehicles.</p> <p>Boswell Road – <b>Object</b> Parking here will block visibility of people exiting the playground (via the yellow gate) and/or impede their ability to cross the road. The area directly alongside the playground exit (and possibly the whole playground) should have DYLS and the visitor parking should be to the east.</p> <p>Frederick Road – <b>Support</b> Essential to stop dangerous parking on the junction corners. If anything, the DYLS should extend further - to the full 10 metres from the junction to match the Highway Code.</p> <p>Bailey Road – <b>Support</b> Essential to stop parking on corners that obscures visibility. The DYLS should really extend further, to a full ten metres from the junction (to match the Highway Code).</p>

	<p>St Lukes Road – <b>Support</b>  With larger width cars, these streets can't support parking on both sides.</p>
<p>(33) Local resident,  (Oxford, The Grates)</p>	<p>Barns Road – <b>Support</b>  Safer cycling</p> <p>Boswell Road – <b>No objection</b></p> <p>Frederick Road – <b>No objection</b></p> <p>Bailey Road – <b>No objection</b></p> <p>St Lukes Road – <b>No objection</b></p>
<p>(34) Local resident,  (Oxford, Bailey Road)</p>	<p>Barns Road – <b>No objection</b>  Checked the website to see that we weren't getting double yellows outside our house</p> <p>Boswell Road – <b>No objection</b>  Fine</p> <p>Frederick Road – <b>Partially support</b>  The parking on the corner is annoying as you can't see round. How about opening up the barrier to phipps road as well. Because its so unnecessary having to drive all the way round. Just have a resident's code to a padlock on it. Anyone who lives there will bother to stop and open it, noone else will</p> <p>Bailey Road – <b>No objection</b>  See Fredrick Road comments.</p> <p>St Lukes Road – <b>No objection</b></p>